

MARTIN AUTOMATIC • THW

Traverse Wound Roll Hot Wire Unwind Splicer

Martin Automatic successfully tackles the problems inherent in unwinding and splicing traverse wound material in a continuous feed operation. The **Martin THW - Traverse Wound Hot Wire Splicing Unwind** provides a space-saving alternative to competitive unwinds on the market, while providing superior tension control of the material as it is fed to the process.

The Martin THW has a pivoting, dual hot-wire splice unit that offers ease of splice preparation for the operator. Splice options available are traditional lap with tape join or heat seal, or Martin's heat seal butt splice which provides a join that is essentially undetectable.

Martin's Inertia-Compensated storage festoon provides precise tension control to the process while providing adequate storage during the splice cycle.

The standard Martin THW is available in models for roll diameters to 51 inches, splicing speeds to 1100 FPM, web widths up to 6 inches, and roll widths to 36 inches. Special configurations are available to meet most specifications.

Provided with patented Martin MC2000 controls, the THW is a drop-in installation offering a total controls system, eliminating the need for conventional drives and PLCs, on low tension, high speed applications. Optional drive and control systems are available.

Contact Martin Automatic Inc for information specific to your application.



Consumer expectations and satisfaction create a demand for quality products. Nonwovens are delivered to the converting process with exact tensions required for application and material.



Martin Engineers Solutions!

THW DIMENSIONS & SPECIFICATIONS

Dimensions shown represent a 6" web width, 50" roll diameter, 1100 FPM machine. Dimensions vary per application and are for planning purpose only.

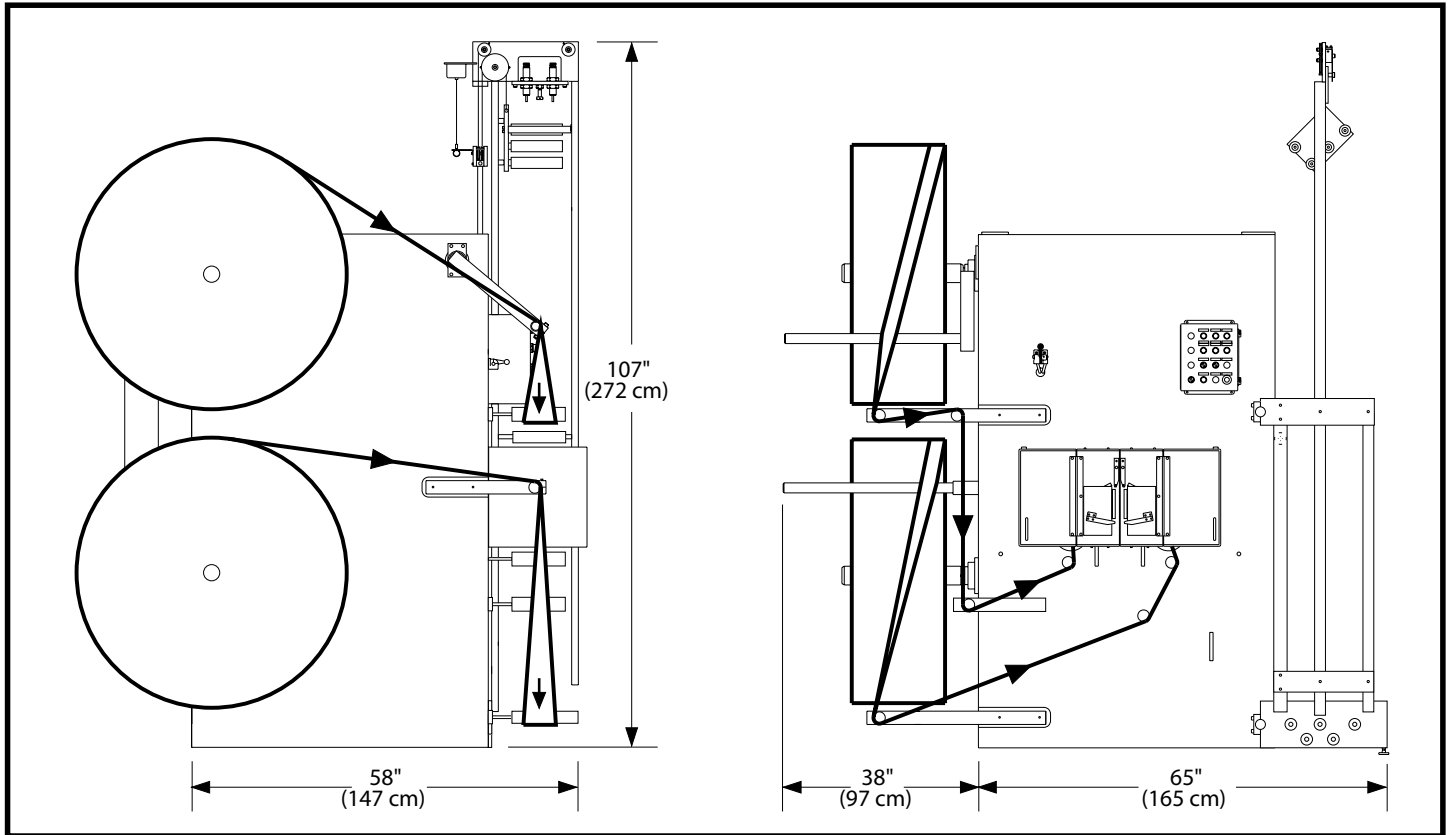

Martin THW Butt or Lap Splicer:

- Martin's pivoting splice head design
- On-the-run pneumatic tension adjustment capability
- Martin's inertia-compensated festoon
- Hot-wire cut-off system
- Application-engineered rollers
- Automatic splice initiation

OPTIONAL

- "Pass-thru" web-up design
- Splice prep warning signal
- Automatic splice initiation
- Heat Seal splice
- Can be outfitted with a Martin Mechanical Knife Splice Unit (MSL)
- Martin's "ROB" package for foam materials**

* Patent pending.

**Turnbar for foam applications providing a non-drag surface. Patent-pending.

SPECIFICATIONS

Maximum Web Width

6 IN	152 MM
------	--------

Maximum Roll Diameter

51 IN	1295 MM
-------	---------

As with all Martin products, the THW is application-engineered to your process. Contact Martin Automatic Inc for more information.



Martin Automatic Inc

1661 Northrock Court
 Rockford, IL 61103, U.S.A.
 Tel: (815) 654-4800
 Fax: (815) 654-4810
 Email: info@martinauto.com
<http://www.martinauto.com>